

CONNEX cPot male adapter axial 10-25mm<sup>2</sup>  
Order-Code: 1027373

Protection class: IP65 (in mated condition)  
Max. current: 100A  
operating temperatur: -40°C bis +125°C

Easy installation due to the supplied  
axial screw contact.  
Wire size: 10 - 25 mm<sup>2</sup>

The cPot connectors for potential distribution  
according to: DIN 15700

Safe connection, cPot locking can only be  
released with a tool.

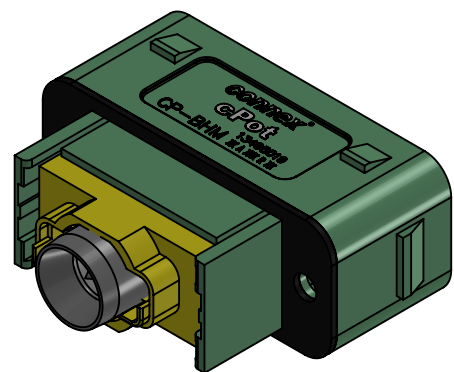

Sheet Number	Projection	Scale	Format	Tolerancing	
1/1		1:1	A4	ISO 2768-	
50 g	cm <sup>2</sup>	22.55 cm <sup>3</sup>	Created	HeBo	31.05.2021
Material			Modified		
Material addition			Approved	DiRo	31.05.2021
Description	CP-PMA		ECN Number		
	cPot panel con M axial 10-25mm <sup>2</sup>		Status	FOR FINAL	
	3D Model ID	Document ID	Revision		
	41027373	1027373	01		