

Index	2	Installation	4
Safety information	2	Lens replacement	5
Content	2	Lens index	6
Technical	3	List of symbols	7
Specifications	3		

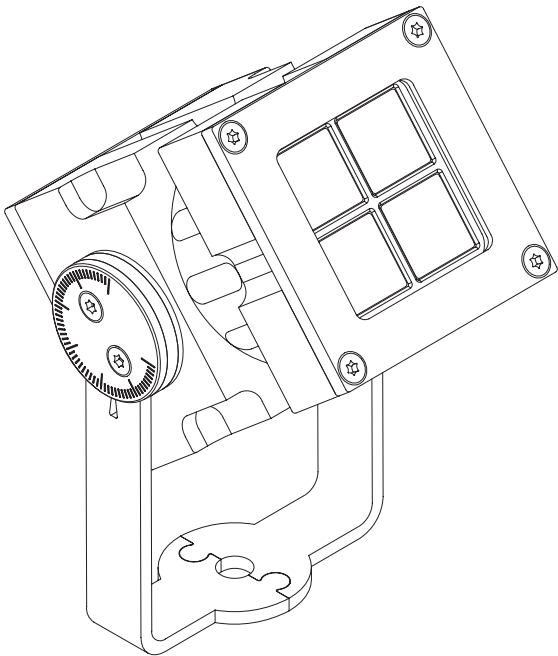

58015

12 x 46°	4 x Cree/Luxeon	IP67	2700K	3000K	4000K	5000K	6500K	Amber	Blue	Red	Green	180-264 VAC	Max. 10 Watt	3 YEARS WARRANTY	CE	A

SAFETY INFORMATION

Make sure all connectors are connected properly	Use a source of AC power that complies local electrical codes	Block access below the work area when maintaining the unit	Don't modify or install genuine parts on this product	Don't install in a flammable or explosive area	

CONTENT

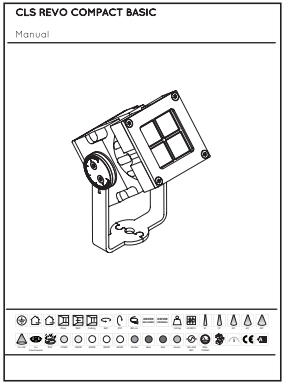
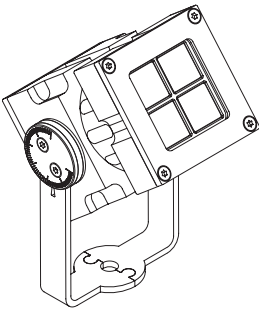

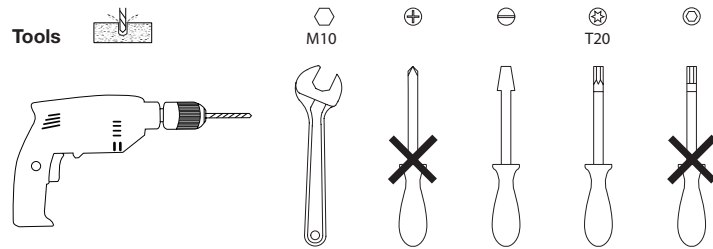
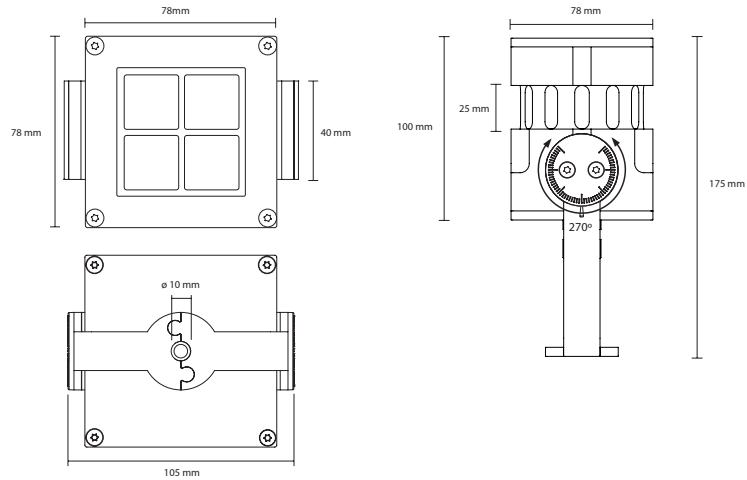

SPECIFICATIONS

LED: 4 x Cree or Luxeon Rebel
 Available colours: 2700K, 3000K, 4000K, 5000K, 6500K, amber, royal blue, red or green
 Lenses: 8°, 12°, 30°, 60°, 80° or 12x46°
 Power supply: 180 ~ 264 VAC / 100 ~ 132 VAC
 Power factor: > 0,92
 Power consumption: Max. 10 Watt
 Housing: Anodised aluminum
 Weight: 1,3 kg
 IP value: IP67
 Cable length: 2 meters
 Measurements: 175 x 105 x 78 mm (h x w x d)
 Ambient temperature: -30° C till +50° C

ACCESSORIES

110415 CLS REVO lens kit superspot 8° 8 pcs of lenses
 110425 CLS REVO lens kit spot 12° 8 pcs of lenses
 110435 CLS REVO lens kit medium flood 30° 8 pcs of lenses
 110445 CLS REVO lens kit wide flood 61° 8 pcs of lenses
 110455 CLS REVO lens kit elliptical 12x46° 8 pcs of lenses
 871992 CLS mold set, straight 8-26mm
 871995 CLS mold set Paguro grey

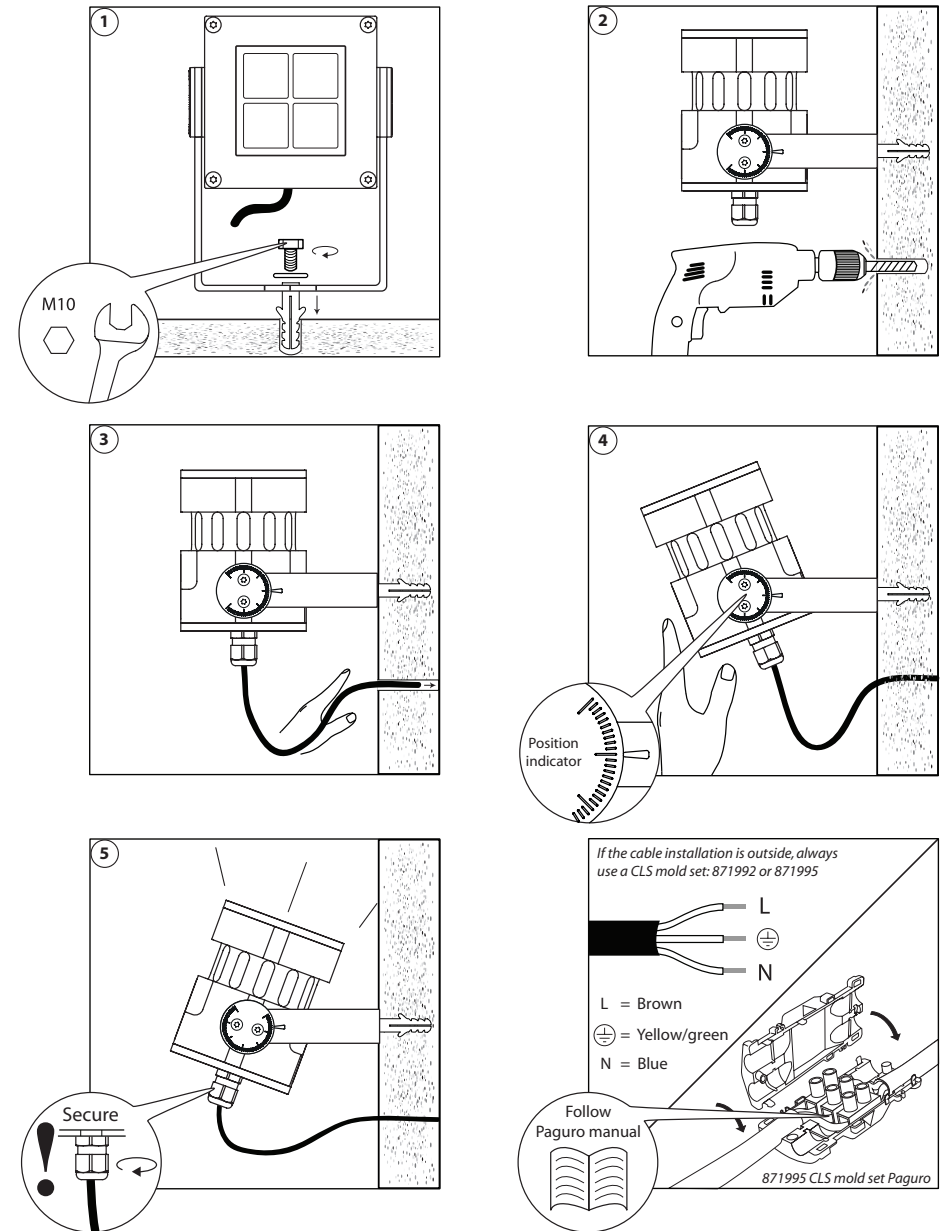

LENS REPLACEMENT

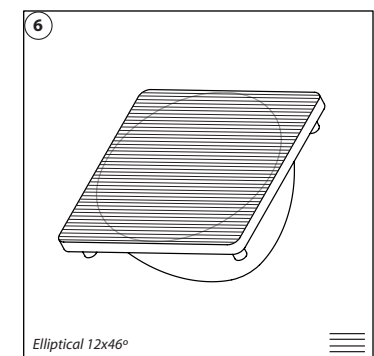
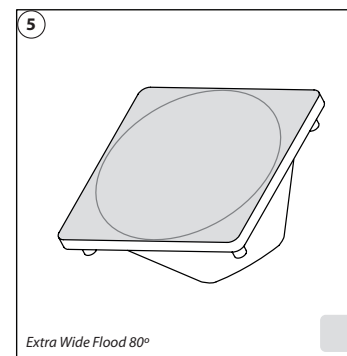
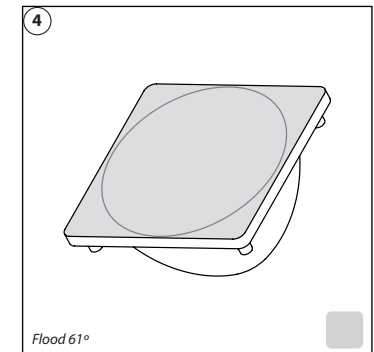
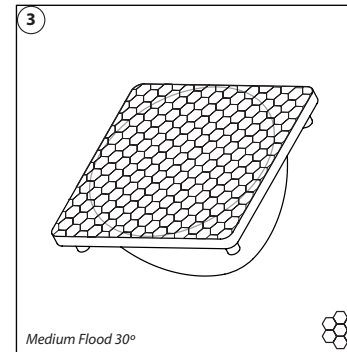
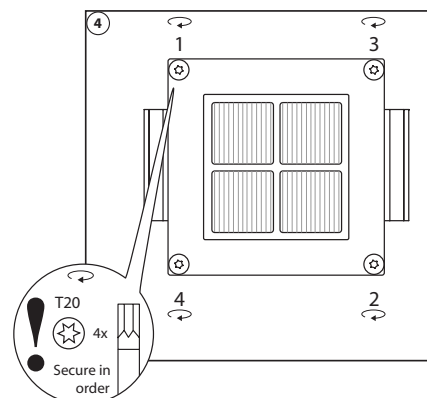
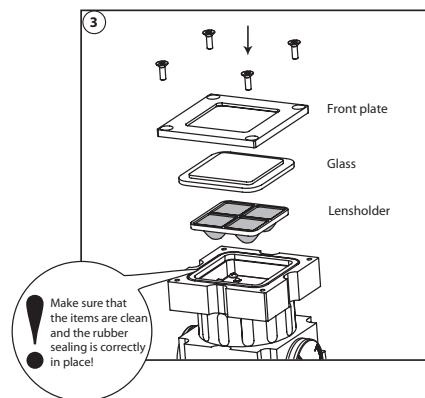
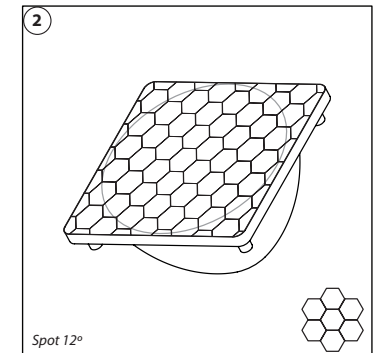
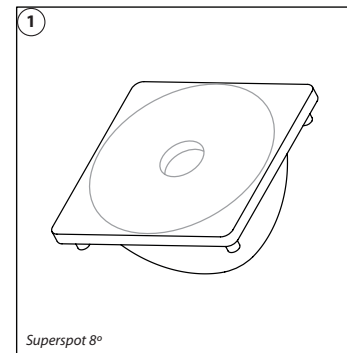
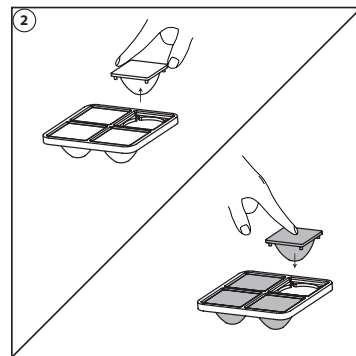
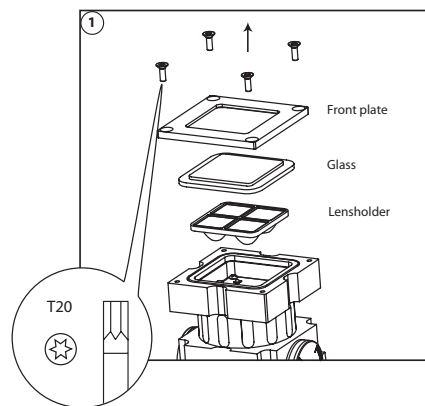

LIST OF SYMBOLS



Protection class
One, two or three



Application area
Indoor or outdoor



Application area
Floor, wall or ceiling



Swivel
Fixture is horizontally rotatable,
indicated in degrees



Swivel
Fixture is vertically rotatable,
indicated in degrees



Multiple connection
Daisychain connectivity



Installation depth
In centimeters



Installation size
In centimeters



Cable length
Maximum cable attached
to the fixture in centimeters



Driver
Inclusive or exclusive
Internal or external



Weight
In grams/kilograms



Pressure
Maximum pressure on the
fixture in kg/cm²



Lifespan
Of the light source in hours



Lenses
Available lenses,
indicated in degrees



Lenses
Available lenses,
indicated in degrees



LEDs
Kind of LED used in the
fixture



Plug & play
Easy connection using the
SmartConnect system



IP value
Ingress Protection classifies the
degrees of protection provided against
the intrusion of the product



Colour changing
RGB, RGB-W, RGB-A,
AWB or Tunable White



Retail & Food LED modules
Clothing, furniture, kitchens, jewellery,
shoes, bread, meat,
fish & vegetables & fruit.



Retail & Food LED modules
Clothing, furniture, kitchens, jewellery,
shoes, bread, meat,
fish & vegetables & fruit.



Colour
Available colours:
Amber, blue, red or green



White colour temperature
In different Kelvin values;
Cold white, neutral white, warm
white or extra warm white



Curve
Minimal bending curve
in centimeters



Cutting length
Indicated by the cutting
marks



LED pitch
Pitch between the LEDs
in millimeters



Power supply
In VDC, VAC or milliAmpere



Power consumption
In VA or Watt



Dimmable
1-10 Volt, Phase, individual,
DMX dimmable or DALI



Bluetooth controlled
By Casambi



Magne dimming
Accurate dimming from
100 - 1% by using a magnet



Dynamic Control
Dynamic Power Control or
Dynamic Temperature Control



DMX input
Fixture works on DMX512
protocol



Combined product
Compose your own fixture



Warranty
3 or 5 years warranty on
the product



Conformité Européenne
CE marking for free marketability
of industrial goods within the EU



Energy label



Lightsource
Equipped with a CLS, Citizen or a Xicato
LED module

2018 CLS-LED BV. All rights reserved. Information subject to change without notice, CLS-LED BV and all affiliated companies disclaim liability for injury, damage direct or indirect loss, consequential or economic loss or any other loss occasioned by the use of, inability to use or reliance on the information contained in this manual. No part of this manual may be reproduced, in any form or by any means, without permission in writing from CLS-LED BV. Other legal information can be found in our General conditions, found on the back of your CLS-LED BV invoice, inside the CLS catalogue or on our website www.cls-led.com/General-Terms.pdf