

Index	2	Installation	4
Safety information	2	Lens replacement	5
Content	2	Lens index	6
Technical	3	List of symbols	7
Specifications	3		

SAFETY INFORMATION

Do not touch the LED surface with bare hands.

Do not use in flammable or explosive areas.

Do not stare into the LED.

Ambiance  
Max. 40°

Qualified technician

Disconnect the power supply before installing or maintaining

Make sure all connectors are connected properly

Use a source of AC power that complies with local electrical codes

Block access below the work area when maintaining the unit

Don't modify or install genuine parts on this product

Don't install in a flammable or explosive area

CONTENT

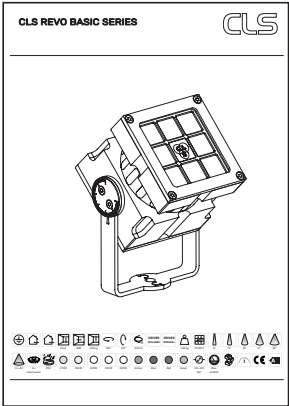
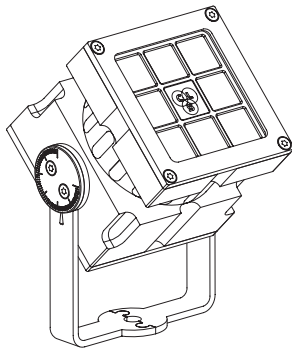

12 x 46°

8 x Cree/Luxeon

IP67

2700K

3000K

4000K

5000K

6500K

Amber

Blue

Red

Green

100-240 VAC

Max. 20 Watt

1,80 kg

50,000 h

8°

12°

30°

61°

80°

Floor

Wall

Ceiling

360°

270°

200 cm

DRIVER INCLUDED

DRIVER INTERNAL

3 YEARS WARRANTY

CE

A

# TECHNICAL

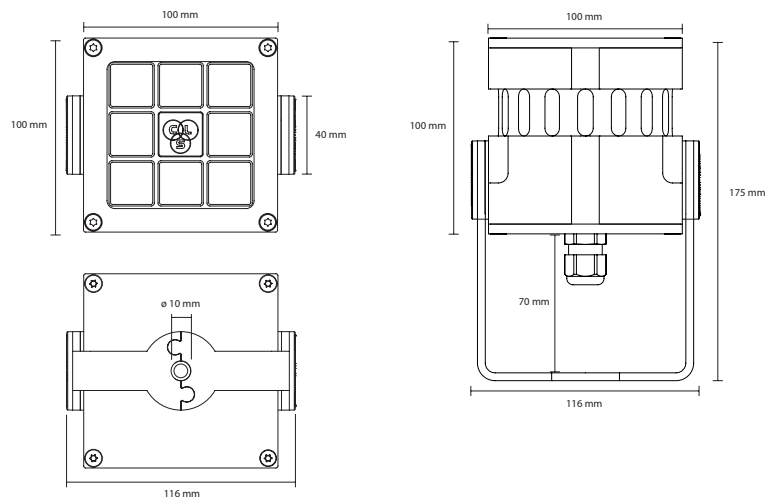

## Tools

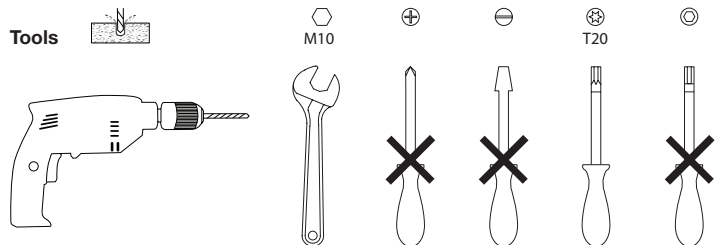

## SPECIFICATIONS

LED: 8 x Cree or Luxeon Rebel  
 Available colours: 2700K, 3000K, 4000K, 5000K, 6500K, amber, red, green and Royal blue  
 Lenses: 8°, 12°, 30°, 61°, 80° and 12x46°  
 Power supply: 100 ~ 240 VAC  
 Power factor: > 0,99 (115VAC), > 0,95 (230VAC)  
 Power consumption: Max. 20 Watt  
 Housing: Anodised aluminum  
 Weight: 1,9 kg  
 IP value: IP67  
 Cable length: 2 meters  
 Measurements: 175 x 116 x 100 mm (h x w x d)  
 Ambient temperature: -30° C till +40° C

## ACCESSORIES

110415 CLS REVO lens kit superspot 8° 8 pcs of lenses  
 110425 CLS REVO lens kit spot 12° 8 pcs of lenses  
 110435 CLS REVO lens kit medium flood 30° 8 pcs of lenses  
 110445 CLS REVO lens kit wide flood 61° 8 pcs of lenses  
 110455 CLS REVO lens kit elliptical 12x46° 8 pcs of lenses  
 871992 CLS mold set, straight 8-26mm  
 871995 CLS mold set Paguro grey

# INSTALLATION

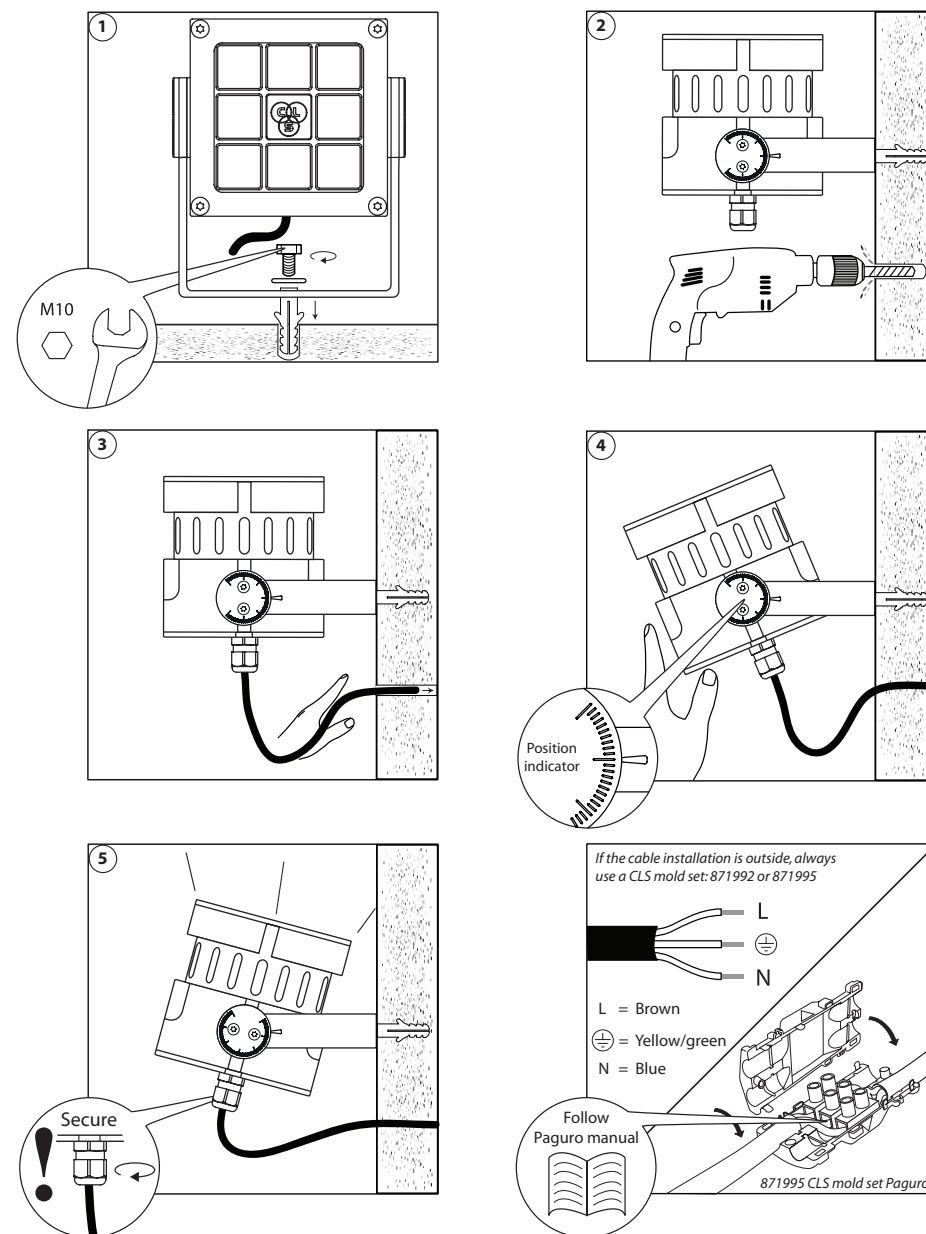

# LENS REPLACEMENT

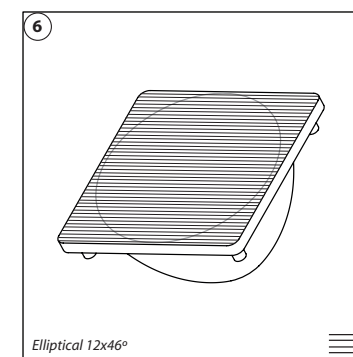
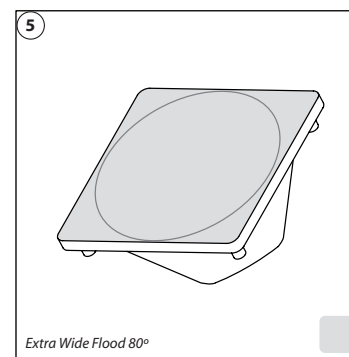
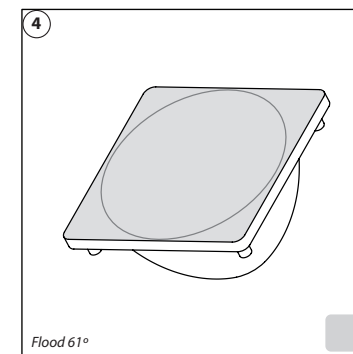
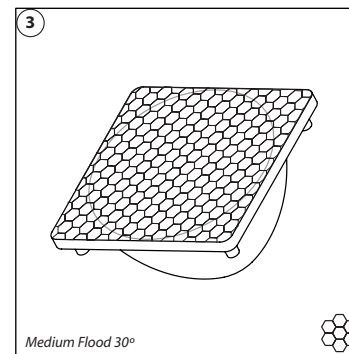
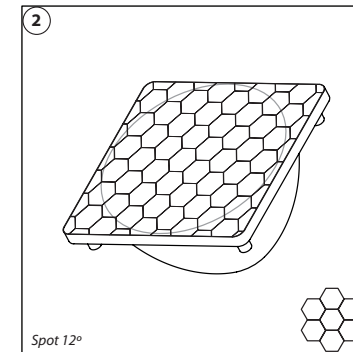
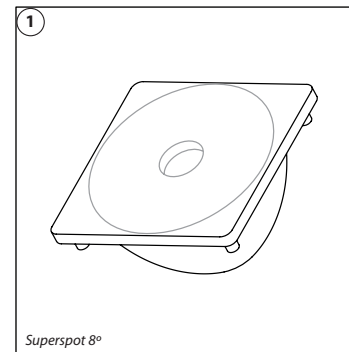
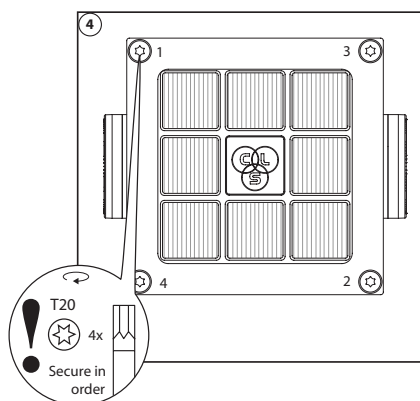
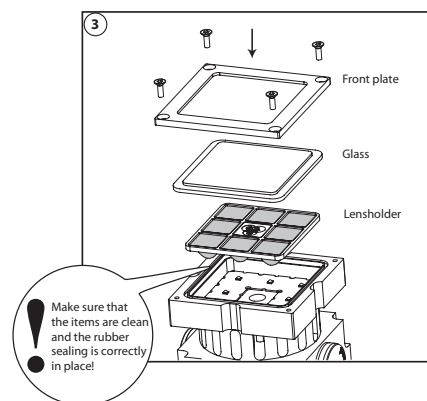
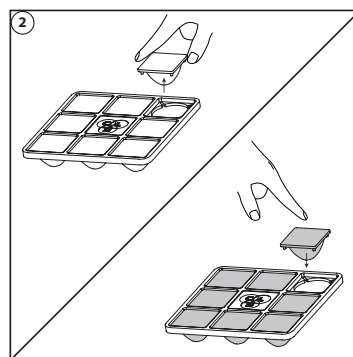
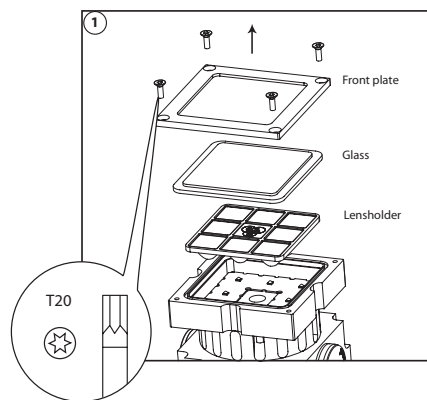

# LIST OF SYMBOLS



**Protection class**  
One, two or three



**Application area**  
Indoor or outdoor



**Application area**  
Floor, wall or ceiling



**Swivel**  
Fixture is horizontally rotatable,  
indicated in degrees



**Swivel**  
Fixture is vertically rotatable,  
indicated in degrees



**Multiple connection**  
Daisychain connectivity



**Installation depth**  
In centimeters



**Installation size**  
In centimeters



**Cable length**  
Maximum cable attached  
to the fixture in centimeters



**Driver**  
Inclusive or exclusive  
Internal or external



**Weight**  
In grams/kilograms



**Pressure**  
Maximum pressure on the  
fixture in kg/cm²



**Lifespan**  
Of the light source in hours



**Lenses**  
Available lenses,  
indicated in degrees



**LEDs**  
Kind of LED used in the  
fixture



**Plug & play**  
Easy connection using the  
SmartConnect system



**IP value**  
Ingress Protection classifies the  
degrees of protection provided against  
the intrusion of the product



**Colour changing**  
RGB, RGB-W, RGB-A,  
AWB or Tunable White



**Retail & Food LED modules**  
Clothing, furniture, kitchens, jewellery,  
shoes, bread, meat,  
fish & vegetables & fruit.



**Colour**  
Available colours:  
Amber, blue, red or green



**White colour temperature**  
In different Kelvin values;  
Cold white, neutral white, warm  
white or extra warm white



**Curve**  
Minimal bending curve  
in centimeters



**Cutting length**  
Indicated by the cutting  
marks



**LED pitch**  
Pitch between the LEDs  
in millimeters



**Power supply**  
In VDC, VAC or milliAmpere



**Power consumption**  
In VA or Watt



**Dimmable**  
1-10 Volt, Phase, individual,  
DMX dimmable or DALI



**Bluetooth controlled**  
By Casambi



**Magne dimming**  
Accurate dimming from  
100 ~ 1% by using a magnet



**Dynamic Control**  
Dynamic Power Control or  
Dynamic Temperature Control



**DMX input**  
Fixture works on DMX512  
protocol



**Combined product**  
Compose your own fixture



**Warranty**  
3 or 5 years warranty on  
the product



**Conformité Européenne**  
CE marking for free marketability  
of industrial goods within the EU



**Energy label**



**Lightsource**  
Equipped with a CLS, Citizen or a Xicato  
LED module

2018 CLS-LED BV. All rights reserved. Information subject to change without notice, CLS-LED BV and all affiliated companies disclaim liability for injury, damage direct or indirect loss, consequential or economic loss or any other loss occasioned by the use of, inability to use or reliance on the information contained in this manual. No part of this manual may be reproduced, in any form or by any means, without permission in writing from CLS-LED BV. Other legal information can be found in our General conditions, found on the back of your CLS-LED BV invoice, inside the CLS catalogue or on our website [www.cls-led.com/General-Terms.pdf](http://www.cls-led.com/General-Terms.pdf)